

THIS DOCUMENT IS THE PROPERTY OF RION TECHNOLOGY(SHENZHEN) LTD.(HEREAFTER"RION"),IT IS LENT AND IS TO BE RETURNED UPON REQUEST,THE CONTENTS OF THIS DOCUMENT ARE CONFIDENTIAL AND CONSTITUTE TRADE SECRETS PROPRIETARY TO RION,THIS DOCUMENT NOR ITS CONTENTS DOCUMENT NOR ITS CONTENTS SHALL BE DISCLOSED TO ANY UNAUTHORISED PERSON COPIED OR PUBLISHED WITHOUT RION PRIOR WRITTEN CONSENT.
COPY RIGHT@2020 RION TECHNOLOGY

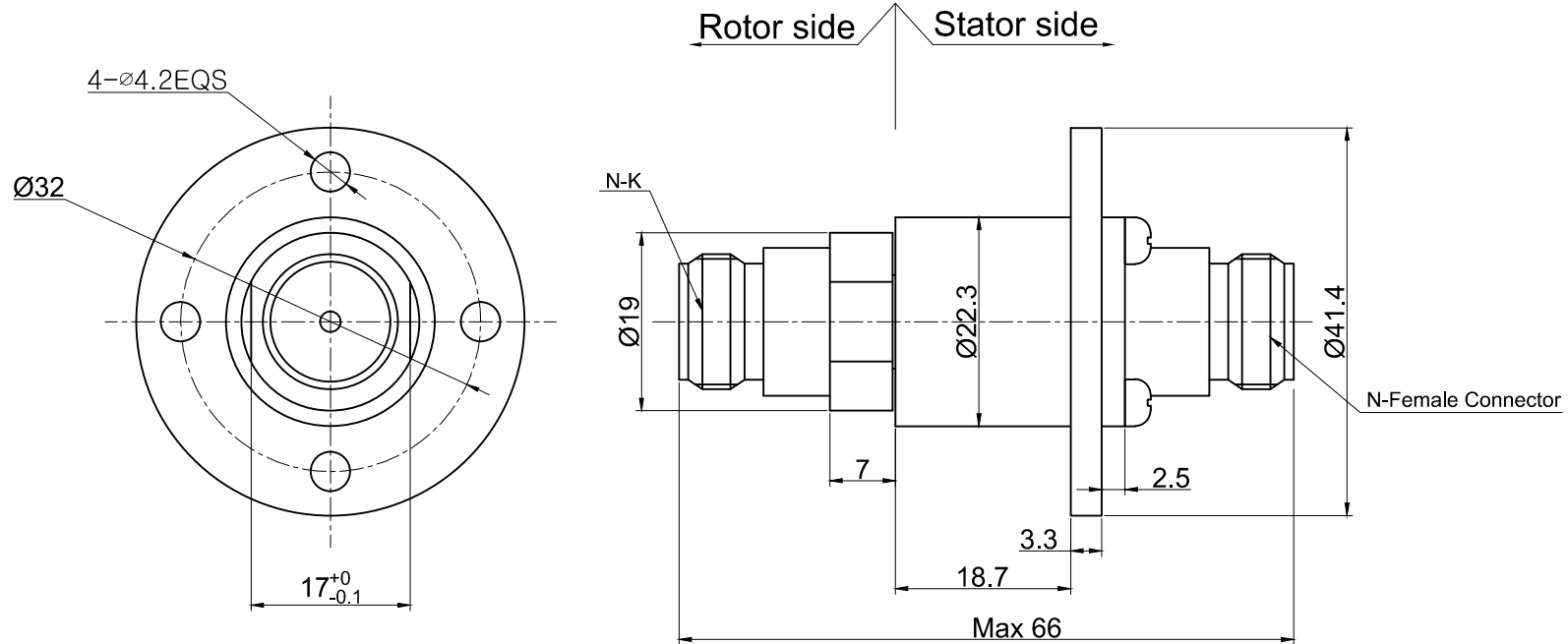

UNLESS OTHERWISE SPECIFIED		TOLERANCES (EXCEPT AS NOTED)		1 channel RF	
1.ALL DIMENSIONS ARE IN MM HES BREAK SHARP EDGES &DEBURR		DECIMAL X±.1		MODEL	RHF100-N-15G
2.MATERIAL&FINISH TO BE AS NOTED OR SUBSTITUTED WITH AN APPROVED AND TESTED EQUIVALENT		XX±.03		SIZE	A
FILLETS R.015	FINISH	XXX±.005		R.E.V.	A / 0
THIRD ANGLE PROJECTION		FRACTIONAL±1/16		SCALE	1:1
		ANGULAR±1°		UNIT	mm

1 frequency	DC-15GHz	2 VSWR(dB)(MAX)	1.35
3 INSERTION LOSS(dB)(MAX)	0.3	4 VSWR-WOW(dB)(MAX)	0.03
5 INSERTION LOSS WOW(dB)(MAX)	0.03	6 Phase-WOW(dB)(MAX)	2°
7 Average power at 1 GHz(W)	500	8 peak power(KW)	10
9 Maximum Speed(RPM)	500RPM	10 CONNECTION	N
11 working temperature(°C)	-55~85	12 Shell material	copper alloy