

THIS DOCUMENT IS THE PROPERTY OF RION TECHNOLOGY(SHENZHEN) LTD.(HEREAFTER"RION"),IT IS LENT AND IS TO BE RETURNED UPON REQUEST,THE CONTENTS OF THIS DOCUMENT ARE CONFIDENTIAL AND CONSTITUTE TRADE SECRETS PROPRIETARY TO RION,THIS DOCUMENT NOR ITS CONTENTS DOCUMENT NOR ITS CONTENTS SHALL BE DISCLOSED TO ANY UNAUTHORIAED PERSON COPIED OR PUBLISHED WITHOUT RION PRIOR WRITTEN CONSENT.
COPY RIGHT@2020 RION TECHNOLOGY

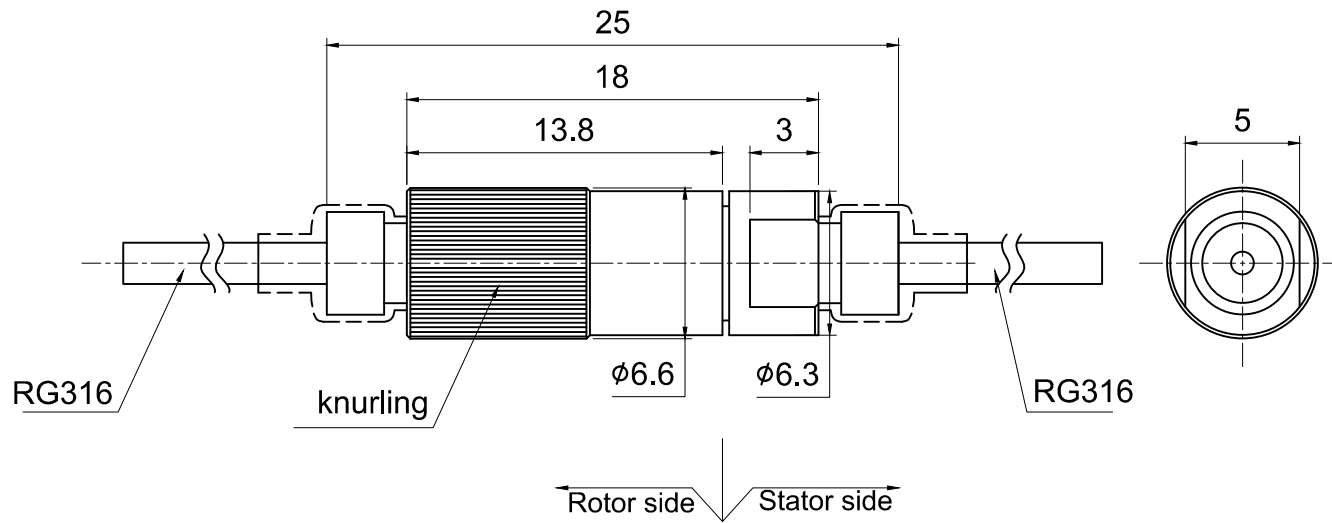

RF Rotary Joint Specifications

1	frequency	DC-15GHz	2	Insertion loss	0.3 dB /1GHz Max
3	Return Loss	-18 dB / 1GHz Max	4	Incorporation loss fluctuation	+/-0.03dB
5	Input and Output	RG -316	6	Voltage standing wave ratio	VSWR≤1.3
7	Maximum Speed	60RPM	8	Impedance	50 ohms
9	Voltage standing wave ratio fluctuation	+/-0.05			
10	Rated current	Direct current MAX.1A			
11	Lead wire	Rotor:300mm Stator:300mm			

UNLESS OTHERWISE SPECIFIED		1 channel RF	
1.ALL DIMENSIONS ARE IN MM HES BREAK SHARP EDGES &DEBURR		TOLERANCES (EXCEPT AS NOTED)	
2.MATERIAL &FINISH TO BE AS NOTED OR SUBSTITUTED WITH AN APPROVED AND TESTED EQUIVALENT		MODEL	RHF100-W50-3G
FILLETS R.015	FINISH <input checked="" type="checkbox"/>	SIZE	A
THIRD ANGLE PROJECTION		R E V.	A / 0
ANGULAR±1°		SCALE	1:1
		UNIT	mm

