

THIS DOCUMENT IS THE PROPERTY OF RION TECHNOLOGY(SHENZHEN) LTD.(HEREAFTER"RION"),IT IS LENT AND IS TO BE RETURNED UPON REQUEST,THE CONTENTS OF THIS DOCUMENT ARE CONFIDENTIAL AND CONSTITUTE TRADE SECRETS PROPRIETARY TO RION,THIS DOCUMENT NOR ITS CONTENTS DOCUMENT NOR ITS CONTENTS SHALL BE DISCLOSED TO ANY UNAUTHORIAED PERSON COPIED OR PUBLISHED WITHOUT RION PRIOR WRITTEN CONSENT.
COPY RIGHT@2020 RION TECHNOLOGY

Rotor side ↕ Stator side

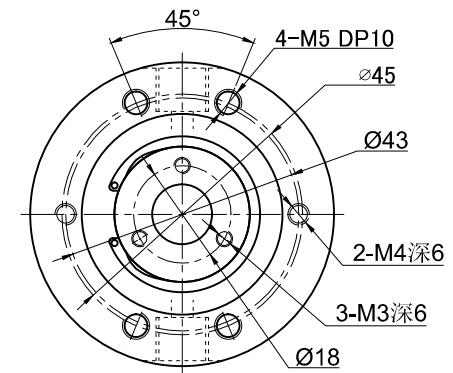
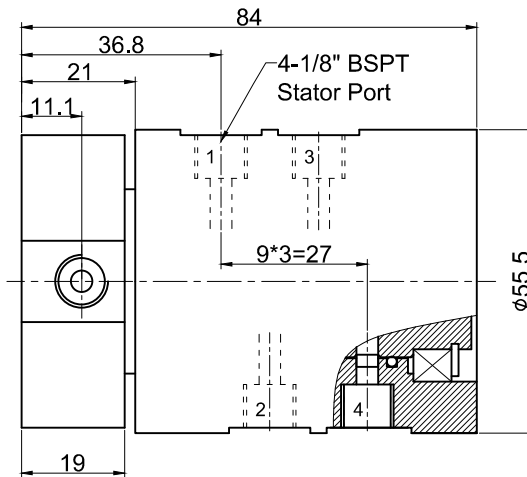
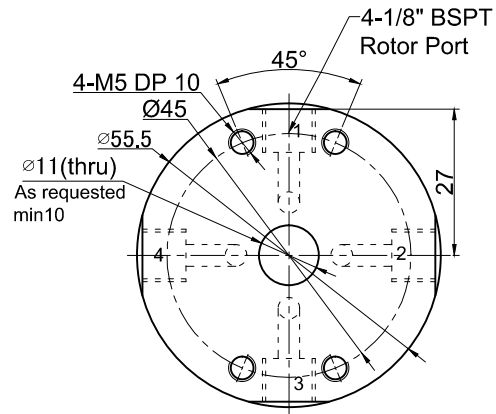

UNLESS OTHERWISE SPECIFIED		TOLERANCES		4 rings gas	
1.ALL DIMENSIONS ARE IN MM HES BREAK SHARP EDGES &DEBURR		EXCEPT AS NOTED		MODEL	
2.MATERIAL &FINISH TO BE AS NOTED OR SUBSTITUTED WITH AN APPROVED AND TESTED EQUIVALENT		DECIMAL X±.1		RK41-N1208	
FILLETS R.015		FINISH		SIZE	
THIRD ANGLE PROJECTION		FRACTIONAL±1/16		A	
ANGULAR±1°		RION		R.E.V. A/0	
				SCALE 1:1	
				UNIT mm	

1	Pressure	Max 1 Mpa	2	Passage	4 passage Gas
3	Torque	Max.2 N.M;	4	Tracheal connector	G1/8"
5	Media type	Compressed air	6	Working temperature	-30℃~+80℃
7	Speed	0-100RPM	8	Storage temperature	-35℃~+85℃
9	Housing material	ALL Alloy			