

THIS DOCUMENT IS THE PROPERTY OF RION TECHNOLOGY(SHENZHEN) LTD.(HEREAFTER"RION"),IT IS LENT AND IS TO BE RETURNED UPON REQUEST,THE CONTENTS OF THIS DOCUMENT ARE CONFIDENTIAL AND CONSTITUTE TRADE SECRETS PROPRIETARY TO RION,THIS DOCUMENT NOR ITS CONTENTS DOCUMENT NOR ITS CONTENTS SHALL BE DISCLOSED TO ANY UNAUTHORIAED PERSON COPIED OR PUBLISHED WITHOUT RION PRIOR WRITTEN CONSENT.
COPY RIGHT@2020 RION TECHNOLOGY

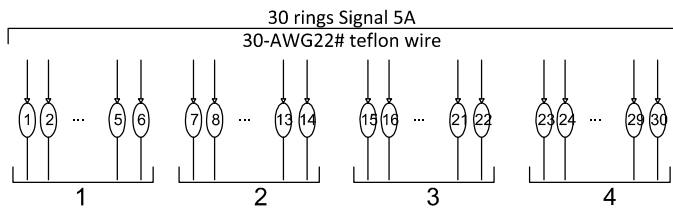
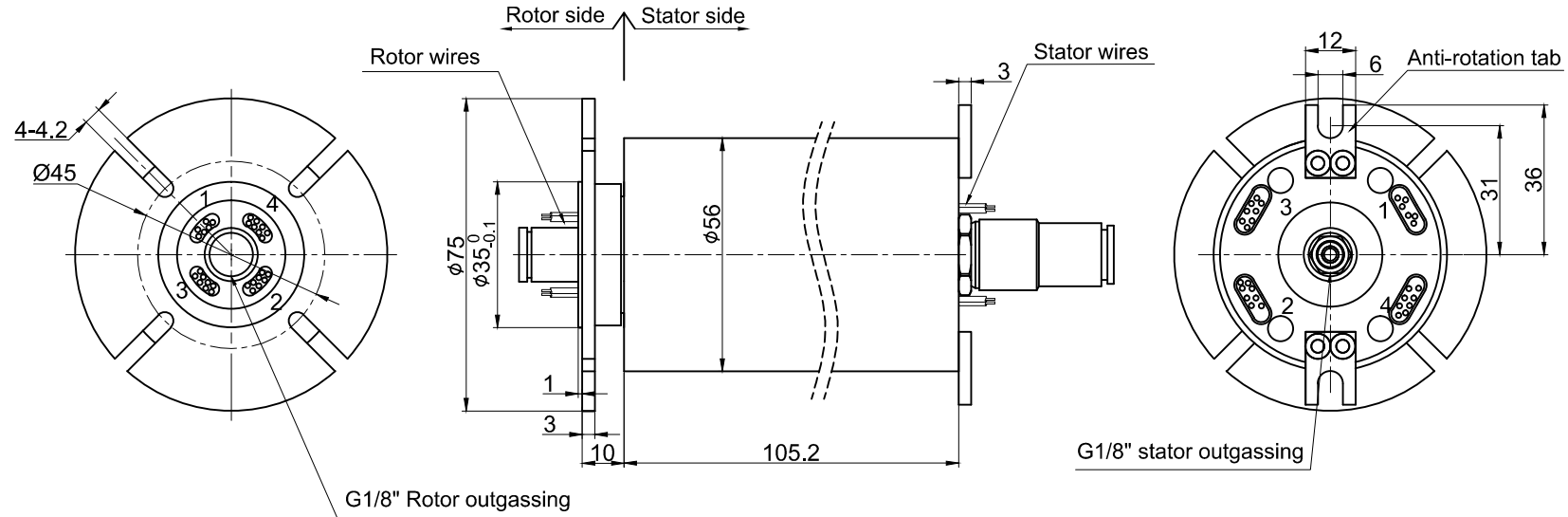

rotary joints specifications	
Passage	1 passage Gar
Channel pressure	<1MPa
Working speed	0-250RPM
Working Temperature	-40°C-80°C
Housing Material	Al Alloy

UNLESS OTHERWISE SPECIFIED		TOLERANCES (EXCEPT AS NOTED)		30 rings Signal	
1. ALL DIMENSIONS ARE IN MM HES BREAK SHARP EDGES & DEBURR		DECIMAL X±.1		MODEL	RAPH100-02-G0801-S30
2. MATERIAL & FINISH TO BE AS NOTED OR SUBSTITUTED WITH AN APPROVED AND TESTED EQUIVALENT		XX±.03		SIZE	A
FILLETS R.015	FINISH <input checked="" type="checkbox"/>	XXX±.005		REV.	A / 0
THIRD ANGLE PROJECTION		FRACTIONAL 1/16		SCALE	1:1
		ANGULAR ±1°		UNIT	mm

Electrical Specification			
1 Rings	30	2 Current	Signal module:30rings, Max:5A/ring
2 Voltage	0-240VDC/VAC		
3 Insulation Resistance	500MΩ@500VDC		
4 Electrical noise	Max.10mΩ;		
5 Dielectric strength	500VAC@50Hz;60S		

Mechanical Specification			
6 Speed	0~250RPM;	7 Torque	Max.0.2 N.M;
8 Life	Typical 30million revolutions, but strongly depends on your working conditions		

Environmental adaptability			
9 Working temperature	-40°C~+80°C	10 Storage temperature	-45°C~+85°C
11 humidity	85±3%(30°C+5°C)		
12 Rush	40g,11ms,Half sine wave, Vertical direction 3 times,Level 3times		
13 IP Class	IP51		

Material/Attachment			
14 Contact Material	noble metal	15 Housing material	AL Alloy+engineering plastic
16 Lead wire	Rotor:300mm(See wiring diagram) Stator:300mm(See wiring diagram)		