

THIS DOCUMENT IS THE PROPERTY OF RION TECHNOLOGY(SHENZHEN) LTD.(HEREAFTER"RION"),IT IS LENT AND IS TO BE RETURNED UPON REQUEST,THE CONTENTS OF THIS DOCUMENT ARE CONFIDENTIAL AND CONSTITUTE TRADE SECRETS PROPRIETARY TO RION,THIS DOCUMENT NOR ITS CONTENTS DOCUMENT NOR ITS CONTENTS SHALL BE DISCLOSED TO ANY UNAUTHORIAED PERSON COPIED OR PUBLISHED WITHOUT RION PRIOR WRITTEN CONSENT.
COPY RIGHT@2023 RION TECHNOLOGY

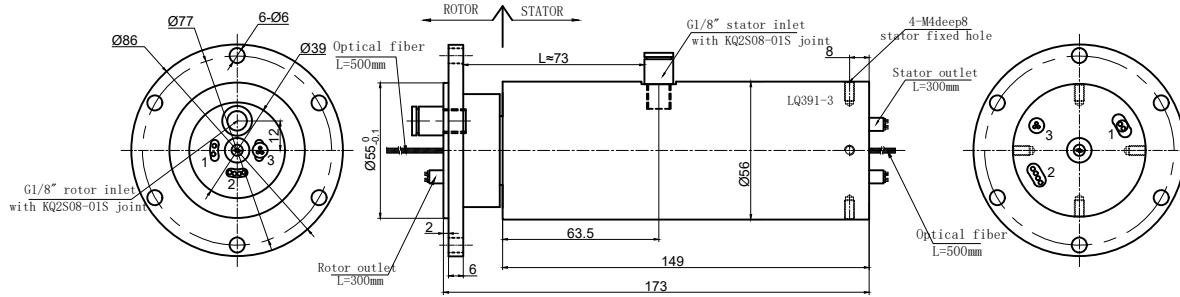

Rotary joint technical parameters	
1 Channel	Tracheal joint G1/8 "
Pressure	Air pressure 1 Mpa
Torsion	T≤1.5N.M
Medium type	compressed air
Maximum speed	0-250 RPM
Temperature	-30° C ~+ 80° C
Material	ALL Alloy

Optical fiber technology parameters	
Optical fiber	1 road single-mode fiber (9/125 μ m)
wavelength	1310nm-1550nm
Insertion loss	< 4 db
Return loss	> 55 db
connector type	FC
Temperature	-40° C ~+ 80° C
length of the fiber	Rotor side; 500 mm (including joint) stator side;500 mm (including joint)

Electrical Specification

1 Rings	5	2 Current	Power module:
2 Voltage	0-380VAC/VDC(High voltage) ; 0-1000VDC(Direct current) ; 0-220VAC/VDC(Signal)		2 rings 5A (Direct current 1000V)
3 Insulation Resistance	1000MΩ@500VDC		+4 rings 10A (High voltage)
4 Electrical noise	Max.10mΩ;		Signal module:
5 Dielectric strength	1000VAC@50HZ.60S(High voltage) ; 0-1000VDC(Direct current) ; 60S 300VAC@50HZ.60S(Signal)		3 rings RS422 (Signal)

Mechanical Specification

6 Speed	0~250RPM;	7 Torque	Max.0.5 N.M;
---------	-----------	----------	--------------

Environmental adaptability

9 Working temperature	-30°C~+80°C	10 Storage temperature	-30 ~+80
11 humidity	85±3%(30°C+5°C)		
12 Rush	40g,11ms,Half sine wave, Vertical direction 3 times,Level 3times		
13 IP Class	IP51		

Material/Attachment

14 Contact Material	noble metal	15 Housing material	ALL Alloy
16 Lead wire	Rotor: 300mm(See wiring diagram) Stator: 300mm(See wiring diagram)		

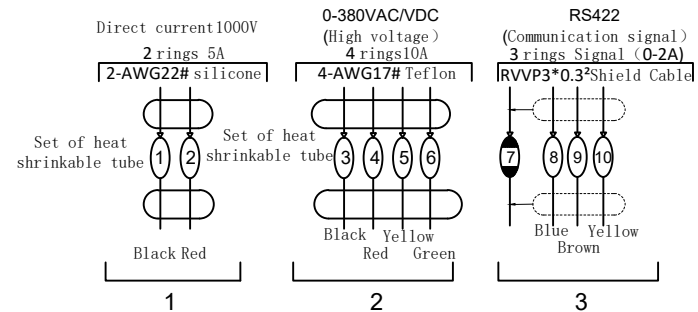

UNLESS OTHERWISE SPECIFIED		TOLERANCES (EXCEPT AS NOTED)		1 channels gas+electricity +Combined fiber optic rotary joint					
1.ALL DIMENSIONS ARE IN MM HES BREAK SHARP EDGES & DEBURR		DECIMAL X±.1		MODEL	REPH100-02-P0410-P0205-S03-1MFO				
2.MATERIAL&FINISH TO BE AS NOTED OR SUBSTITUTED WITH AN APPROVED AND TESTED EQUIVALENT		XX±.03			SIZE	A			
FILLETS R.015		XXX±.005			RE.V	A / 0			
FINISH		FRACTIONAL±1/16		SCALE	1:1				
THIRD ANGLE PROJECTION		ANGULAR±1°		DWG.NO	FSD	DATE	2022-11-09	UNIT	mm