

THIS DOCUMENT IS THE PROPERTY OF RION TECHNOLOGY(SHENZHEN) LTD.(HEREAFTER"RION"),IT IS LENT AND IS TO BE RETURNED UPON REQUEST,THE CONTENTS OF THIS DOCUMENT ARE CONFIDENTIAL AND CONSTITUTE TRADE SECRETS PROPRIETARY TO RION,THIS DOCUMENT NOR ITS CONTENTS DOCUMENT NOR ITS CONTENTS SHALL BE DISCLOSED TO ANY UNAUTHORIAED PERSON COPIED OR PUBLISHED WITHOUT RION PRIOR WRITTEN CONSENT.
COPY RIGHT@2023 RION TECHNOLOGY

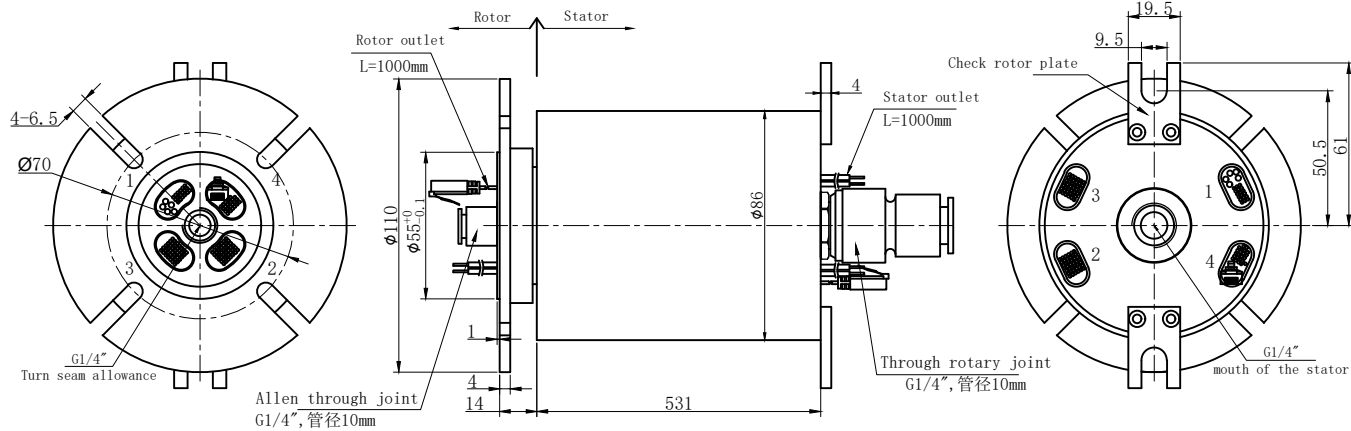

Rotary joint technical parameters	
1 Channel	Tracheal sub G1/4" 10 mm trachea
Pressure	Air pressure 1 Mpa
Torsion	T≤2 N.M
Medium type	compressed air
Maximum speed	100 RPM
Temperature	-30° C ~+ 80° C
Material	ALL Alloy

Electrical Specification

1 Rings	139	2 Current	Power module:5 rings ,10A/ring Signal module: 125 rings signal +1-1000M net
2 Voltage	0-300VAC/VDC		
3 Insulation Resistance	500MΩ@600VDC		
4 Electrical noise	Max.10mΩ;		
5 Dielectric strength	600VAC@50Hz;60S		

Mechanical Specification

6 Speed	0~250RPM;	7 Torque	Max.2 N.M;
---------	-----------	----------	------------

Environmental adaptability

9 Working temperature	-30℃~+80℃	10 Storage temperature	-30℃~+80℃
11 humidity	85±3%(30℃+5℃)		
12 Rush	40g,11ms,Half sine wave, Vertical direction 3 times,Level 3times		
13 IP Class	IP51		

Material/Attachment

14 Contact Material	noble matal	15 Housing material	ALL Alloy
16 Lead wire	Rotor: (See wiring diagram) Stator: (See wiring diagram)		

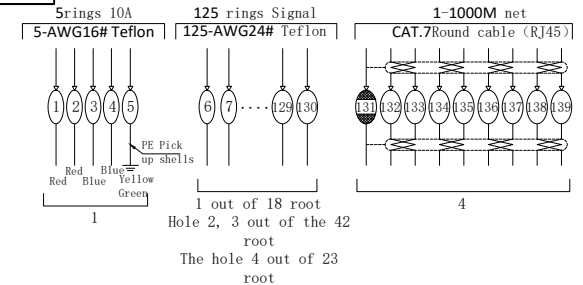

UNLESS OTHERWISE SPECIFIED		TOLERANCES (EXCEPT AS NOTED)		5 rings 10A+125 rings Signal+1-1000M net			
1.ALL DIMENSIONS ARE IN MM HES BREAK SHARP EDGES &DEBURR		DECIMAL X±.1		MODEL	REPH100-03-G1001-P0510-S125-1E		
2.MATERIAL &FINISH TO BE AS NOTED OR SUBSTITUTED WITH AN APPROVED AND TESTED EQUIVALENT		XX±.03		RION	SIZE	A	
FILLETS R.015		XXX±.005			RE V.	A / 0	
THIRD ANGLE PROJECTION		FRACTIONAL ±1/16		DWG.NO	FSD	DATE	2022-11-09
ANGULAR ±1°		ANGULAR ±1°		UNIT	mm		