

THIS DOCUMENT IS THE PROPERTY OF RION TECHNOLOGY(SHENZHEN) LTD.(HEREAFTER"RION"),IT IS LENT AND IS TO BE RETURNED UPON REQUEST,THE CONTENTS OF THIS DOCUMENT ARE CONFIDENTIAL AND CONSTITUTE TRADE SECRETS PROPRIETARY TO RION,THIS DOCUMENT NOR ITS CONTENTS DOCUMENT NOR ITS CONTENTS SHALL BE DISCLOSED TO ANY UNAUTHORIAED PERSON COPIED OR PUBLISHED WITHOUT RION PRIOR WRITTEN CONSENT.
COPY RIGHT@2023 RION TECHNOLOGY

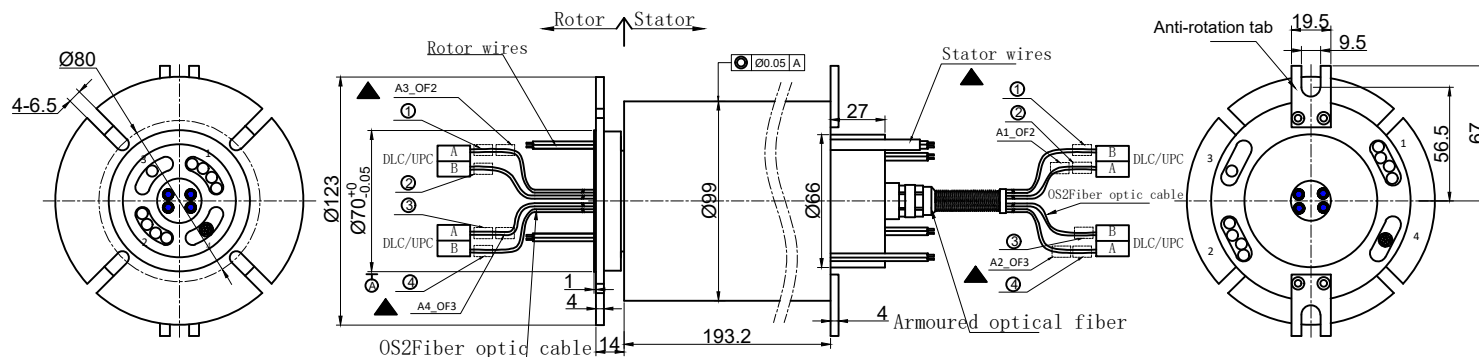

1. Electricity department don't set reduction set, set of corrugated pipe orifice (1/2 power cord sets a set)
2. Optical fiber winding pipe

Optical fiber technology parameters	
Optical fiber	4 road single-mode fiber (Armoured optical fiber)
wavelength	1310/1550
Insertion loss	< 2.5 db
Return loss	> 50 db
connector type	DLC/UPC*2
Temperature	-40° C ~+ 85° C
length of the fiber	Rotor side: 400 mm (Contains no joint) stator side:400 mm (Contains no joint)

Electrical Specification

1 Rings	16	2 Current	Power module: 8 rings ,50A/ring Signal module: 1 rings 30A +6 rings signal
2 Voltage	0-240VAC/VDC		
3 Insulation Resistance	500MΩ@500VDC		
4 Electrical noise	Max.10mΩ; <small>Static resistance<=5mΩ On both sides of the rotor with cable<=20mΩ</small>		
5 Dielectric strength	2500VAC@50HZ,60S (89%50A)	500VAC@50HZ,60S (other ring)	

Mechanical Specification

6 Speed	0~200RPM;	7 Torque	Max.0.5 N.M;
---------	-----------	----------	--------------

Environmental adaptability

9 Working temperature	-40°C~+80°C	10 Storage temperature	-40 ~+80
11 humidity	85±3%(30°C+5°C)		
12 Rush	40g,11ms,Half sine wave, Vertical direction 3 times,Level 3times		
13 IP Class	IP54		

Material/Attachment

14 Contact Material	noble matal	15 Housing material	ALL Alloy
16 Lead wire	Rotor: (See wiring diagram) Stator: (See wiring diagram)		

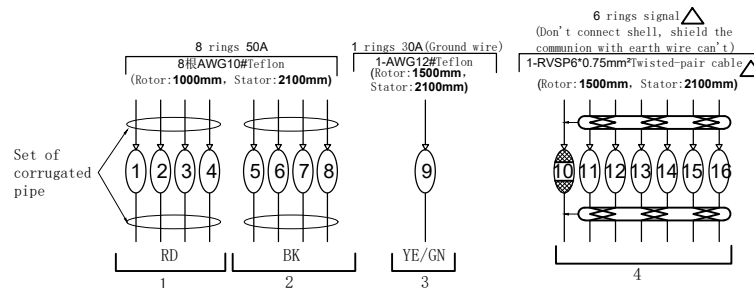

UNLESS OTHERWISE SPECIFIED		TOLERANCES (EXCEPT AS NOTED)		MODEL RFO408C-P0850-P0130-S06					
1. ALL DIMENSIONS ARE IN MM HES BREAK SHARP EDGES & DEBURR		DECIMAL X±.1 XX±.03 XXX±.005			SIZE	A			
2. MATERIAL & FINISH TO BE AS NOTED OR SUBSTITUTED WITH AN APPROVED AND TESTED EQUIVALENT		FRACTIONAL ±1/16 ANGULAR ±1°			RE V.	A / 0			
FILLET R.015	FINISH ✓	THIRD ANGLE PROJECTION		DWG. NO.	FSD	DATE	2022-11-09	SCALE	1:1
				UNIT	mm				