

THIS DOCUMENT IS THE PROPERTY OF RION TECHNOLOGY(SHENZHEN) LTD.(HEREAFTER"RION"),IT IS LENT AND IS TO BE RETURNED UPON REQUEST,THE CONTENTS OF THIS DOCUMENT ARE CONFIDENTIAL AND CONSTITUTE TRADE SECRETS PROPRIETARY TO RION,THIS DOCUMENT NOR ITS CONTENTS DOCUMENT NOR ITS CONTENTS SHALL BE DISCLOSED TO ANY UNAUTHORIAED PERSON COPIED OR PUBLISHED WITHOUT RION PRIOR WRITTEN CONSENT.  
COPY RIGHT@2023 RION TECHNOLOGY

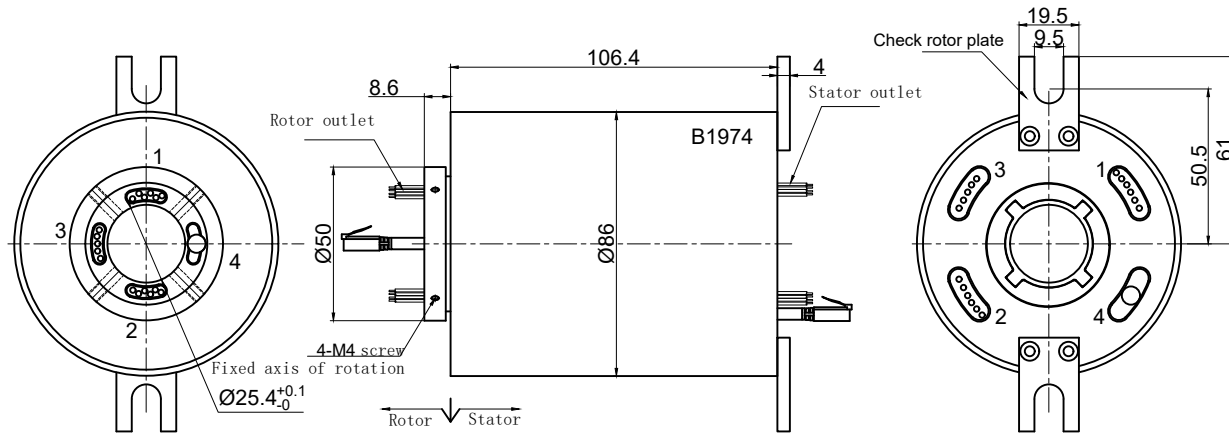

### Electrical Specification

1 Rings	22	2 Current	Power module:17 rings ,10A/ring Signal module: 1 channel Industrial Ethernet signal
2 Voltage	0-440VAC/VDC		
3 Insulation Resistance	500M $\Omega$ @600VDC		
4 Electrical noise	Max.6m $\Omega$ ;		
5 Dielectric strength	1000VAC@50Hz;60S No breakdown		

### Mechanical Specification

6 Speed	0~250RPM;	7 Torque	Max.0.5 N.M.;
---------	-----------	----------	---------------

### Environmental adaptability

9 Working temperature	-30 $^{\circ}$ C~+80 $^{\circ}$ C	10 Storage temperature	-30 ~+80
11 humidity	85 $\pm$ 3%(30 $^{\circ}$ C+5 $^{\circ}$ C)		
12 Rush	40g,11ms,Half sine wave, Vertical direction 3 times,Level 3times		
13 IP Class	IP51		

### Material/Attachment

14 Contact Material	noble metal	15 Housing material	ALL Alloy+Engineering plastics
16 Lead wire	Rotor: Rotor outlet 4100mm,Set of heat shrinkable tube length4000mm(See wiring diagram) Stator: Stator outlet 500mm,Set of heat shrinkable tube length400mm(See wiring diagram)		

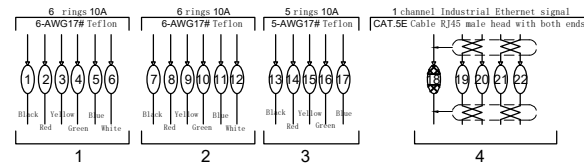

UNLESS OTHERWISE SPECIFIED 1.ALL DIMENSIONS ARE IN MM HES BREAK SHARP EDGES &DEBURR 2.MATERIAL&FINISH TO BE AS NOTED OR SUBSTITUTED WITH AN APPROVED AND TESTED EQUIVALENT	TOLERANCES (EXCEPT AS NOTED)	17 rings 10A +1 channel Industrial Ethernet signal	
	DECIMAL X $\pm$ .1 XX $\pm$ .03 XXX $\pm$ .005	MODEL	RT2586-P1710-1E
FILLET'S R.015 FINISH $\checkmark$	THIRD ANGLE PROJECTION 	FRACTIONAL $\pm$ 1/16 ANGULAR $\pm$ 1 $^{\circ}$	 SIZE A R E V. A / 0 SCALE 1:1 UNIT mm