

MARK	ECN NO.	Modify	Approve	DATE

THIS DOCUMENT IS THE PROPERTY OF RION TECHNOLOGY(SHENZHEN) LTD.(HEREAFTER"RION"),IT IS LENT AND IS TO BE RETURNED UPON REQUEST,THE CONTENTS OF THIS DOCUMENT ARE CONFIDENTIAL AND CONSTITUTE TRADE SECRETS PROPRIETARY TO RION,THIS DOCUMENT NOR ITS CONTENTS DOCUMENT NOR ITS CONTENTS SHALL BE DISCLOSED TO ANY UNAUTHORIAED PERSON COPIED OR PUBLISHED WITHOUT RION PRIOR WRITTEN CONSENT.
COPY RIGHT@2026 RION TECHNOLOGY

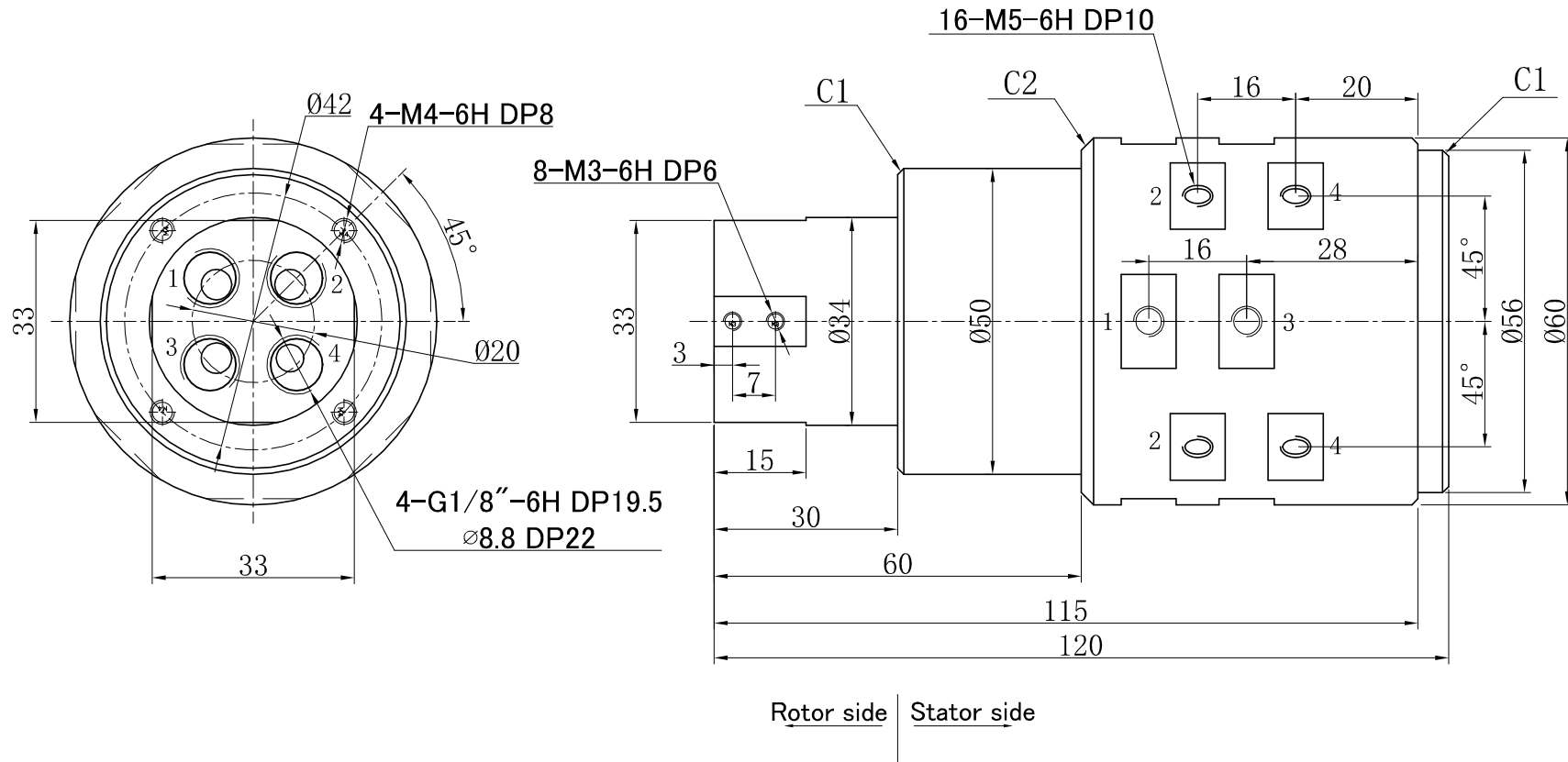

Rotor side | Stator side

Technical parameters of rotary joint

1	Pressure	Max 1Mpa	2	Passage	Every passages input 4 passages output
3	Torque	Max.5 N.M;	4	Tracheal connector	G1/8" Input M5 Output
5	Media type	Compressed air	6	Working temperature	-30°C~+80°C
7	Speed	0-250RPM	8	Storage temperature	-35°C~+85°C
9	Texture of materia	Al Alloy			

UNLESS OTHERWISE SPECIFIED		TOLERANCES (EXCEPT AS NOTED)		Every passages input 4 passages output	
1.ALL DIMENSIONS ARE IN MM HES BREAK SHARP EDGES &DEBURR.		SIZE RANGE	TOLERANCE	MODEL	RX26061008
2.MATERIAL&FINISH TO BE AS NOTED OR SUBSTITUTED WITH AN APPROVED AND TESTED EQUIVALENT.		X < 6	±0.1		
FILLETS R.015		6 ≤ X < 30	±0.2		
FINISH ✓		30 ≤ X < 120	±0.3		
THIRD ANGLE PROJECTION		120 ≤ X < 400	±0.5		
FRACTIONAL±1/16 ANGULAR±1° (3,3)		400 ≤ X < 1000	±0.8		
RION		1000 ≤ X	±1.2		
				SIZE	A
				RE V.	A / 0
				SCALE	1:1
				UNIT	mm