

MARK	ECN NO.	Modify	Approve	DATE

THIS DOCUMENT IS THE PROPERTY OF RION TECHNOLOGY(SHENZHEN) LTD.(HEREAFTER"RION"),IT IS LENT AND IS TO BE RETURNED UPON REQUEST,THE CONTENTS OF THIS DOCUMENT ARE CONFIDENTIAL AND CONSTITUTE TRADE SECRETS PROPRIETARY TO RION,THIS DOCUMENT NOR ITS CONTENTS DOCUMENT NOR ITS CONTENTS SHALL BE DISCLOSED TO ANY UNAUTHORIAED PERSON COPIED OR PUBLISHED WITHOUT RION PRIOR WRITTEN CONSENT.
COPY RIGHT@2026 RION TECHNOLOGY

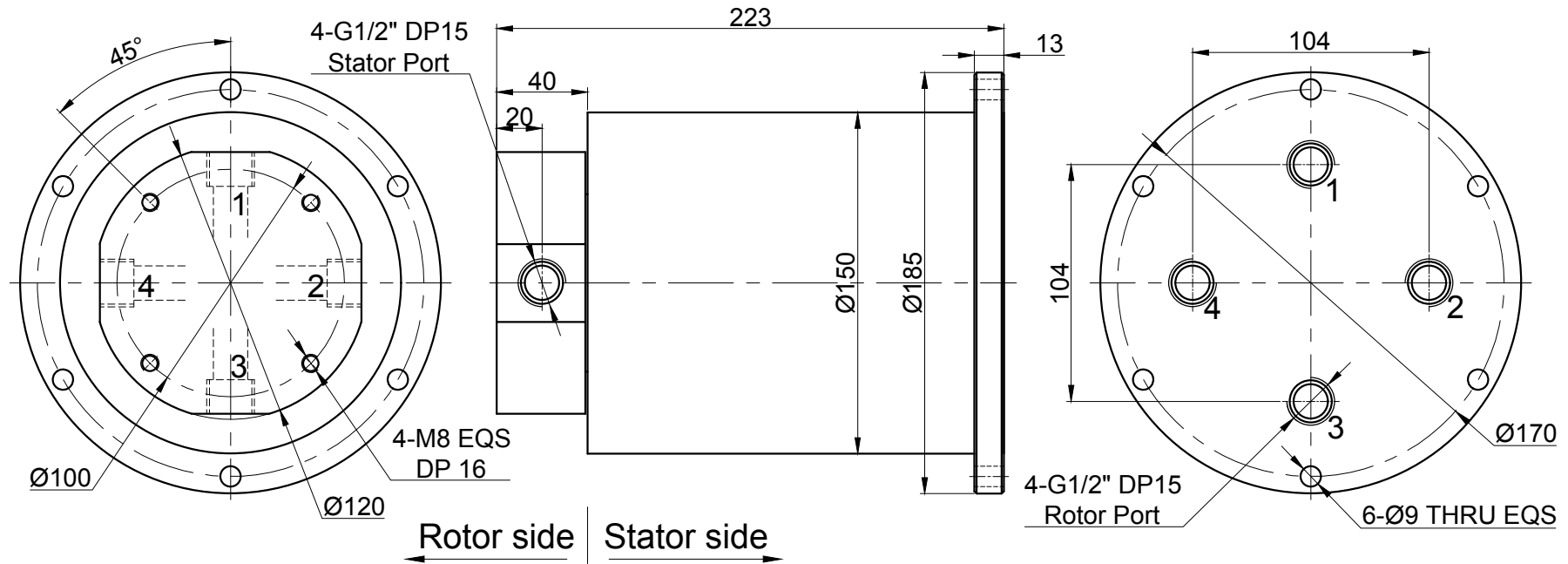

UNLESS OTHERWISE SPECIFIED		TOLERANCES (EXCEPT AS NOTED)		4 Passage Liquids	
1.ALL DIMENSIONS ARE IN MM HES BREAK SHARP EDGES &DEBURR.		SIZE RANGE TOLERANCE		MODEL RX26062310	
2.MATERIAL&FINISH TO BE AS NOTED OR SUBSTITUTED WITH AN APPROVED AND TESTED EQUIVALENT.		X < 6	±0.1	SIZE	A
FILLETS R.015		6 ≤ X < 30	±0.2	RE V.	A / 0
FINISH ✓		30 ≤ X < 120	±0.3	SCALE	1:1
THIRD ANGLE PROJECTION		120 ≤ X < 400	±0.5	UNIT	mm
FRACTIONAL ±1/16		400 ≤ X < 1000	±0.8	RION	
ANGULAR ±1°		1000 ≤ X	±1.2	(4.4)	

Technical parameters of rotary joint					
1	Pressure	0.4 MPa	2	Passage	4 Passage
3	Torque	Max. 20 N·m	4	Tracheal connector	G1/2"
5	Media type	50% G40 ethylene glycol + 50% water	6	Working temperature	-20℃~+65℃
7	Speed	0~10 rpm	8	Storage temperature	-25℃~+70℃
9	Texture of materia	Al alloy + Carbon steel			